

Courses from Hic. thence
 up the River
 S. 29. E. 150
 S. 37 E. 130
 S. 3. W. 38
 S. 52. W. 80
 N. 71. W. 116 to hict

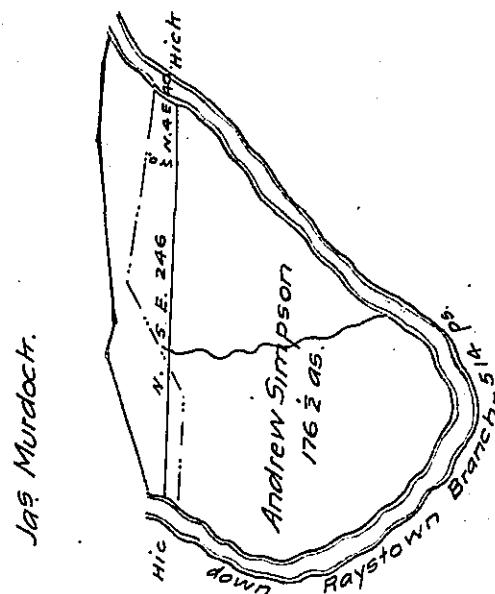

Situate on the West Side of the Raystown Branch below James Murdochs in Hopewell Township
 Huntingdon County, Containing one hundred and seventy six and one half acres and allowance
 Surveyed for Andrew Simpson on order No. 1461 dated 10th day of October, 1766
 To Jacob Spangler Esq, S. G. Daniel Africa D.S.

The dotted lines and river represent the draught of a survey in the name of John McMath made
 on Order No. 1214, dated the 13th day of September 1766. This survey interferes one hundred and seventy
 three and one half acres with the Andrew Simpson survey. John McMath conveyed to John Foshee and
 Benjamin Knidd. John Foshee conveyed his moiety to Benjamin Knidd, who devised the whole tract
 to John Knidd, who conveyed to Jacob Didwiler, who conveyed to Jacob Grub, whose heirs now own and
 occupy this tract.

The green and river lines represent the draught of a tract of land surveyed for John Owens, Jr.
 on order No. 332 dated the 1st of August, 1766. This tract interferes one hundred and seventy six acres
 and one half acres with the Andrew Simpson tract. John Owens, Jr. conveyed to James Dailey
 who conveyed to William Blackburn, who conveyed to William Morris, who conveyed to Jacob Didwiler,
 who conveyed to Jacob Grub, whose heirs now own & occupy the land.

No. 1214, ~~not~~ Pat'd

No. 332, ~~not~~ Pat'd

IN TESTIMONY that the above is a copy of the original remaining on file in the Department of
 Internal Affairs of Pennsylvania, made conformably to an Act of Assembly
 approved the 16th day of February, 1833, I have hereunto set my Hand
 and caused the Seal of said Department to be affixed at Harrisburg, this
 twentieth day of June 1911.

Nancy Houck
 Secretary of Internal Affairs.